

ACCESSORY SPECIFICATIONS

1. PRODUCT NAME

Rigid Vinyl
Accoustical Ceiling
Accessories
Rigid Vinyl also known as PVC
(Unplasticized Chloride)

2. MANUFACTURER

VINYL CORP.™
8000 N.W. 79th Place
Miami, Florida 33166
Phone: 305/477-6464
Fax: 305/477-4108
National Watts:
800/648-4695

3. PRODUCT DESCRIPTION

Drywall & Veneer accessories are manufactured by Vinyl Corp.™, using lead-free, virgin vinyl compounds, formulated to have durability and toughness.

Drywall & Veneer Accessories: Corner Beads, Arch Beads, Bullnose Beads, Bullnose Arch Beads, J-beads, Bullnose J-Beads, Stop Beads, Adjustable Corner Trim, Reveals, L-Beads, Channel Reveal Intersections, "F" Channel Reveals, Partition End Caps, Control Joints, "F" Control Joints, Soffit Vents, and other miscellaneous vinyl accessories.

Durability: They are impervious to corrosion when coated with veneer plaster, wet joint compounds or when placed in contact with steel or aluminum frames. Vinyl accessories do not contain plasticizers which could migrate to the surface.

Impact Resistance: Due to superior impact resistance, rigid vinyl accessories are resistant to dents and kinks of corners and edges, during construction.

Corrosion Resistance: Vinyl accessories are impervious to rust, corrosion, galvanic corrosion, electrolysis, and are not affected by fast setting joint compounds or topping compounds.

Solid Color: Standard color is white
Paint Adhesion Properties: Excellent, no priming is required.

Ignition Resistance: Rigid vinyl is self extinguishing, and will not continue to support combustion once flame source is removed, therefore it will not cause a fire to re-start or spread. It offers better resistance to burning than many other common building materials.

Electrical Conductivity: Rigid vinyl possesses low electrical conductivity.

Thermal Conductivity: Rigid vinyl is warm to the touch and has a very low transmission of heat or cold, and it is considered an excellent insulator.

Expansion and Contraction: Vinyl Corp.™ wall & ceiling accessories are manufactured, when needed, with perforations in the flanges to allow finishing compounds or veneer plaster to flow thru and bond to wallboard. Perforated flanges remain embedded in matrix to reinforce the edges and corners. These factors, along with the fastening of accessories to substrate prior to coating, makes the accessories part of the building unit and therefore will move with it as the temperature changes. Consequently the coefficient of expansion of rigid vinyl has little or no bearing on the installation.

Basic Uses: To produce durable, straight edges, corners, smooth curvatures, arches and soffit ventilation. To protect and preserve edges of wallboard from impact and condensation.

4. TECHNICAL DATA

Applicable Standards:

ASTM C1047

ASTM D3678 Class 2

Limitations: Not recommended for exterior applications unless noted by exterior ASTM specification number.

5 INSTALLATION

Applicable Standards:

Installation shall be in accordance with ASTM standards and prevalent industry standards and good practices. Vinyl accessories shall be mechanically fastened to substrate in straight lines or smooth curves.

6. AVAILABILITY AND COSTS

Vinyl Corp.™ accessories are generally priced lower than equivalent products manufactured in galvanized steel and substantially lower than zinc or aluminum. Vinyl Corp.™ accessories are in stock and will usually be shipped within 24 hours after receipt of order. Accessories are marketed nationwide thru distributors and building supply dealers.

7. PACKAGING

275 lb. test, double wall, corrugated boxes.

8. WARRANTY INFORMATION

Available upon request.

Note: All size references are nominal dimensions and subject to normal manufacturing tolerances. All product lengths are 10' unless otherwise noted.

MATERIAL DATA

MINIMUM PROPERTIES	ASTM	@0°F	@32°F	@72°F
Tensile Strength, psi	D-638			6,500
Tensile Modulus, psi	D-638			335,000
Flexural Strength, psi	D-790			10,900
Flexural Modulus, psi	D-790			382,000
Izod Impact(ft.-lbs./in.)	D-256			2
MISCELLANEOUS MINIMUM PROPERTIES		ASTM		@72°F
Heat Distortion Temperature (°F @ 264 psi)		D-648		167
Coefficient of Linear Thermal Expansion (in./in. °F x 10 ⁻⁵)		D-696		3.60
Durometer "D" Hardness				83
Specific Gravity				1.47



Index

Acoustical Ceiling Specifications	4-1	Acoustical Reveal	4-6
VCE Expansion Joints (Installation Between Tees)	4-5	Reveal Board	4-7
VCE Expansion Joints (Installation Between Wall and Tee)	4-5	Stucco/Plaster Accessory Index	1-2
VCE Expansion Joints (Installation on Wall to Drywall)	4-5	EIFS/DEFS Accessory Index	2-2
VCE Expansion Joints (Installation Drywall to Drywall)	4-5	Drywall/Veneer Accessory Index	3-2
Ground Reveal	4-6		

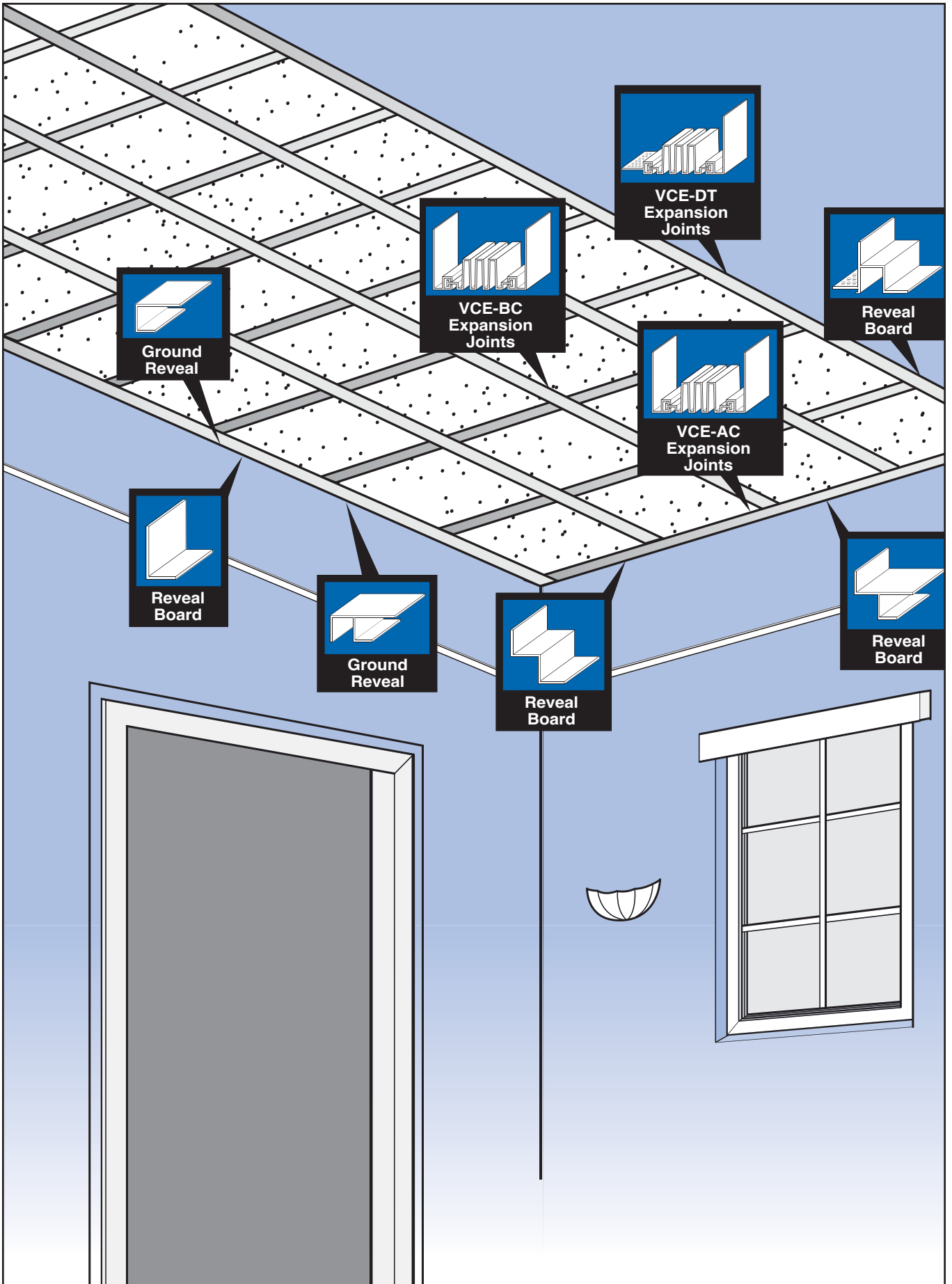

Acoustical Ceiling

Profile Guide

4-5

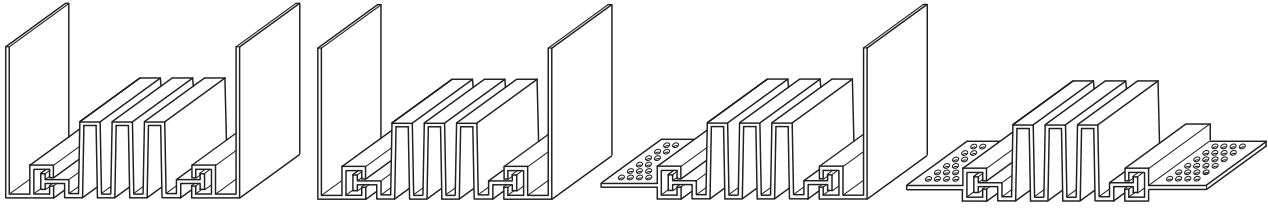

4-6

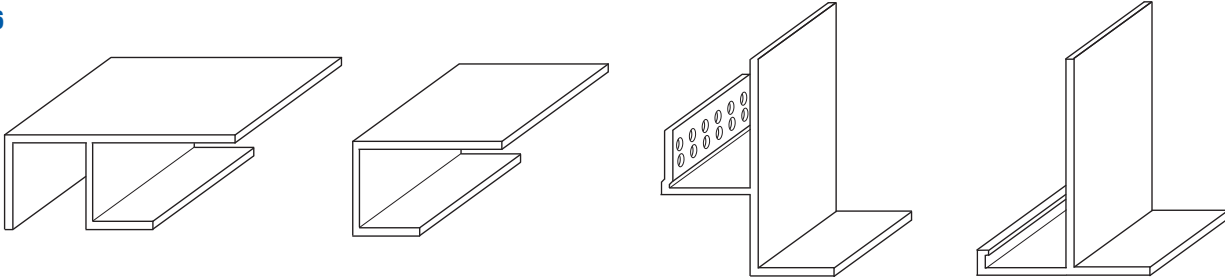

4-7

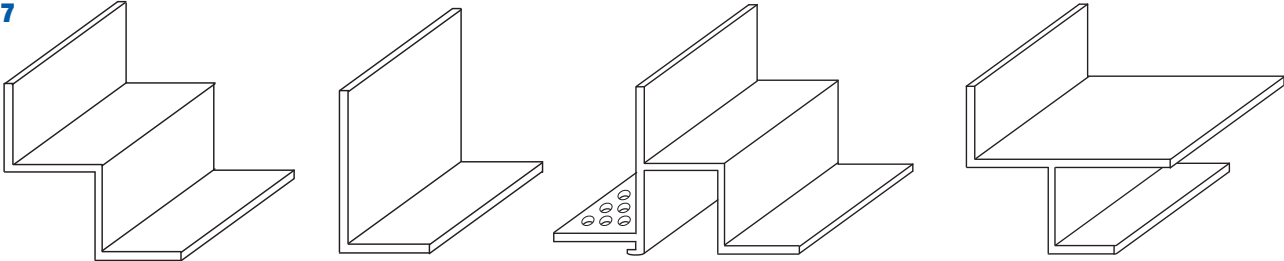

PRODUCT NUMBER	BOARD	PIECES PER BOX
VCE-AC flexible 1" to 2" PVC	ALL	20
VCE-AC-W flexible to 3" PVC	ALL	15
VCE vinyl surface wall or ceiling system can be use flat or curved.		

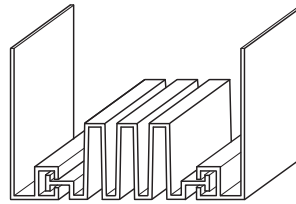

VCE Expansion Joints

(Installation between Tees)

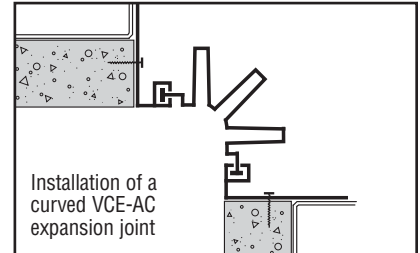
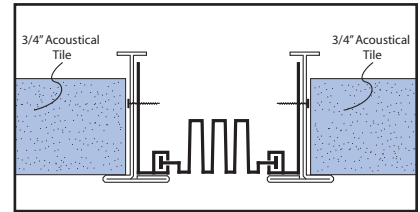

PRODUCT NUMBER	BOARD	PIECES PER BOX
VCE-BC flexible 1" to 2" PVC	ALL	20
Standard color white. Design to be used between main tees, or against wall.		

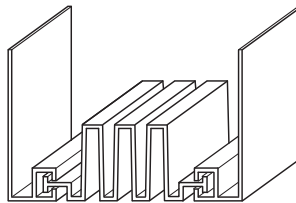

VCE Expansion Joints

(Installation between Wall & Tees)

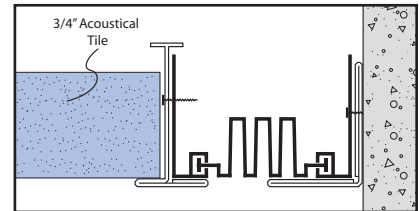

PRODUCT NUMBER	BOARD	PIECES PER BOX
VCE-DT flexible 1" to 2" PVC	ALL	20
Standard color white. Design to be used between wall & ceiling attached to the main tees.		

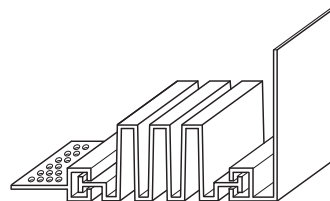

VCE Expansion Joints

(Installation on Wall to Drywall)

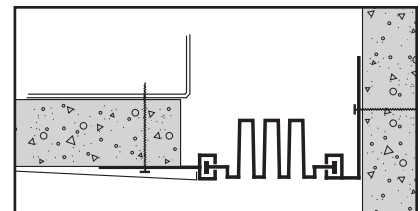

PRODUCT NUMBER	BOARD	PIECES PER BOX
VCE-DW flexible 1" to 2" PVC	ALL	20
VCE-DW-W flexible to 3" PVC	ALL	15
VCE vinyl surface wall or ceiling system can be use flat or curved.		

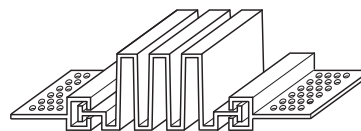

VCE Expansion Joints

(Installation Drywall to Drywall)

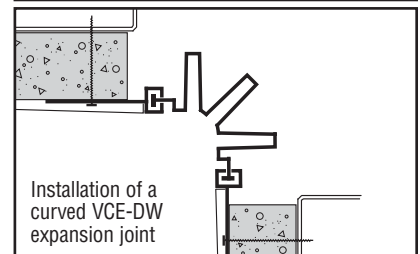
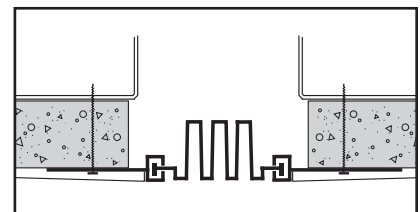

Ground Reveals

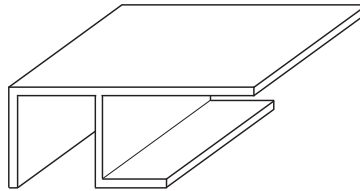
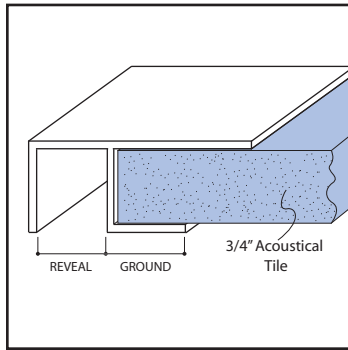

PRODUCT NUMBER	BOARD	REVEAL	PIECES PER BOX
ACOF-78-50	3/4" acoustical tile	1/2"	25
ACOF-78-75		3/4"	25
ACOF-78-100		1"	25
ACOF-78-150		1-1/2"	25
ACOF-100-75	1" acoustical board	3/4"	25

Product reveal used at perimeter or acoustical ceiling and wall.

Ground Reveals

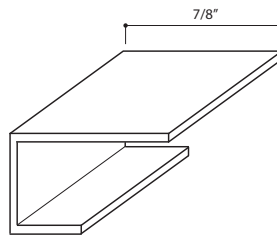
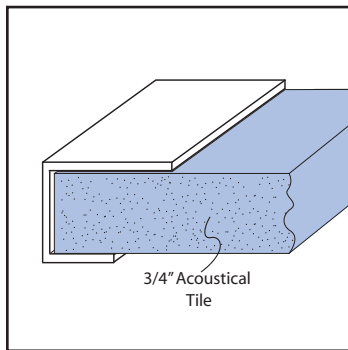

PRODUCT NUMBER	BOARD	PIECES PER BOX
ACJB-78	3/4"	25

Product is used to cap Acoustical Tile.

Acoustical Reveals

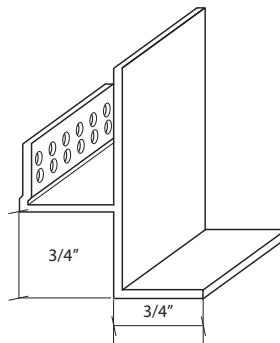
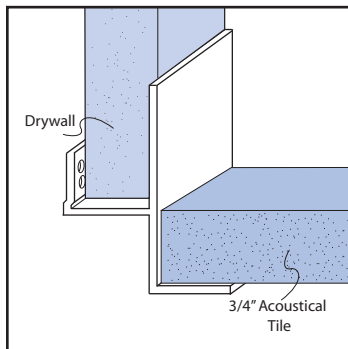

PRODUCT NUMBER	BOARD	REVEAL	PIECES PER BOX
ACUFR-50-75	3/4" acoustical tile	1/2"	25
ACUFR-58-75		5/8"	25
ACUFR-75-75		3/4"	25

Product reveal outside edge use at corner of vertical facia. Horizontal leg supports acoustical ceiling.

Acoustical Reveals

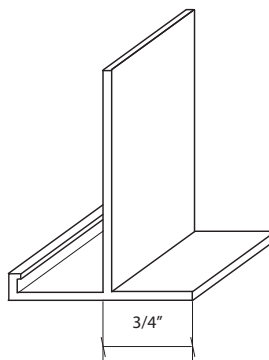
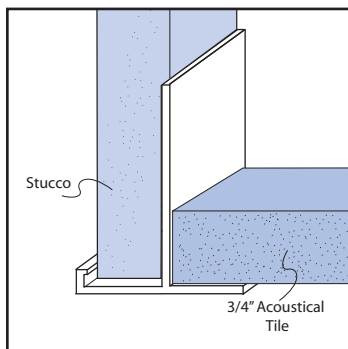

PRODUCT NUMBER	BOARD	PIECES PER BOX
ACUT-75-78	3/4"	25

Product is used on outside trim corner of facia and soffit. Support leg for Acoustical.

PRODUCT NUMBER	BOARD	PIECES PER BOX
ACUW-50-75	3/4"	25
ACUW-75-75	3/4"	25

Product Edge Trim can be used as a reveal around acoustical ceiling.

Reveal Board

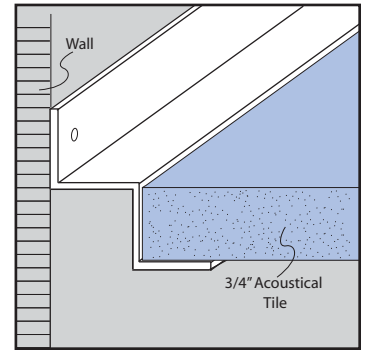
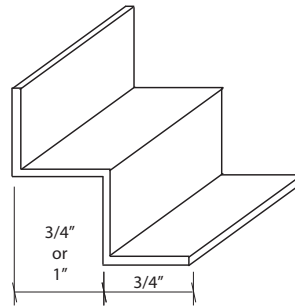

PRODUCT NUMBER	BOARD	PIECES PER BOX
ACUA	3/4"	20

Product wall angle serves as support leg acoustical ceiling.

Reveal Board

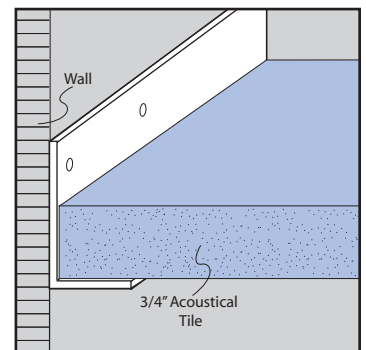
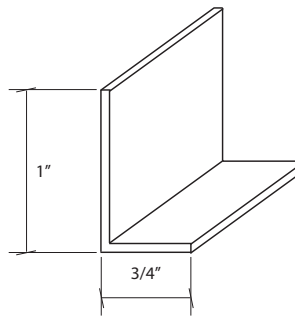

PRODUCT NUMBER	BOARD	PIECES PER BOX
ACUDR-50-50	3/4"	25
ACUDR-50-75	3/4"	25

Product Drywall and acoustical reveal use when acoustical ceiling meets drywall ceiling. Reveal is provided.

Reveal Board

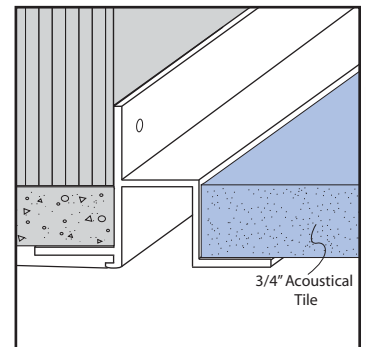
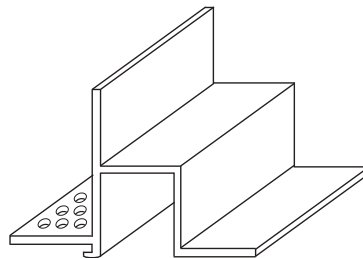

PRODUCT NUMBER	BOARD	PIECES PER BOX
ACUWR-75-78	3/4"	30

Product reveal provides clean termination for installation with 7/8" acoustic tile. Install with appropriate fastener to wall.

Reveal Board

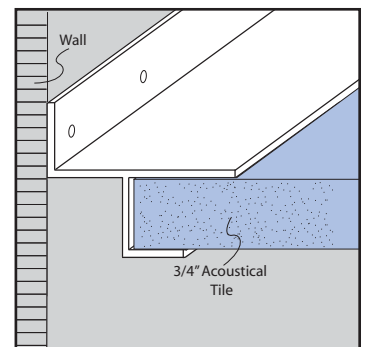
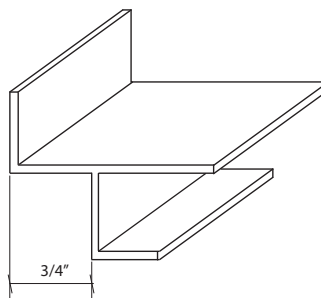

Acoustical Ceiling



Vinyl Corp. Trademarks

Vinyl Corp.[™], Archmaker[™], Archmaker Series[™], Bandmaker[™],
Bandmaker Series[™] and Keylock[™]

Vinyl Corp. Patents

U.S. Patent Nos. 5,816,002; 5,946,870; 5,970,671; 6,070,374;
6,119,429; 6,134,847; and 6,298,609



Vinyl Corp.[™] • 8000 NW 79th Place • Miami, FL 33166
800.648.4695 • 305.477.6464 • Fax: 305.477.4108

Stucco & Plaster

EIFS & DEFS

Drywall & Veneer

Acoustical Ceiling

Roof Flashing